

TRAFFIC CONTROL LAYOUT

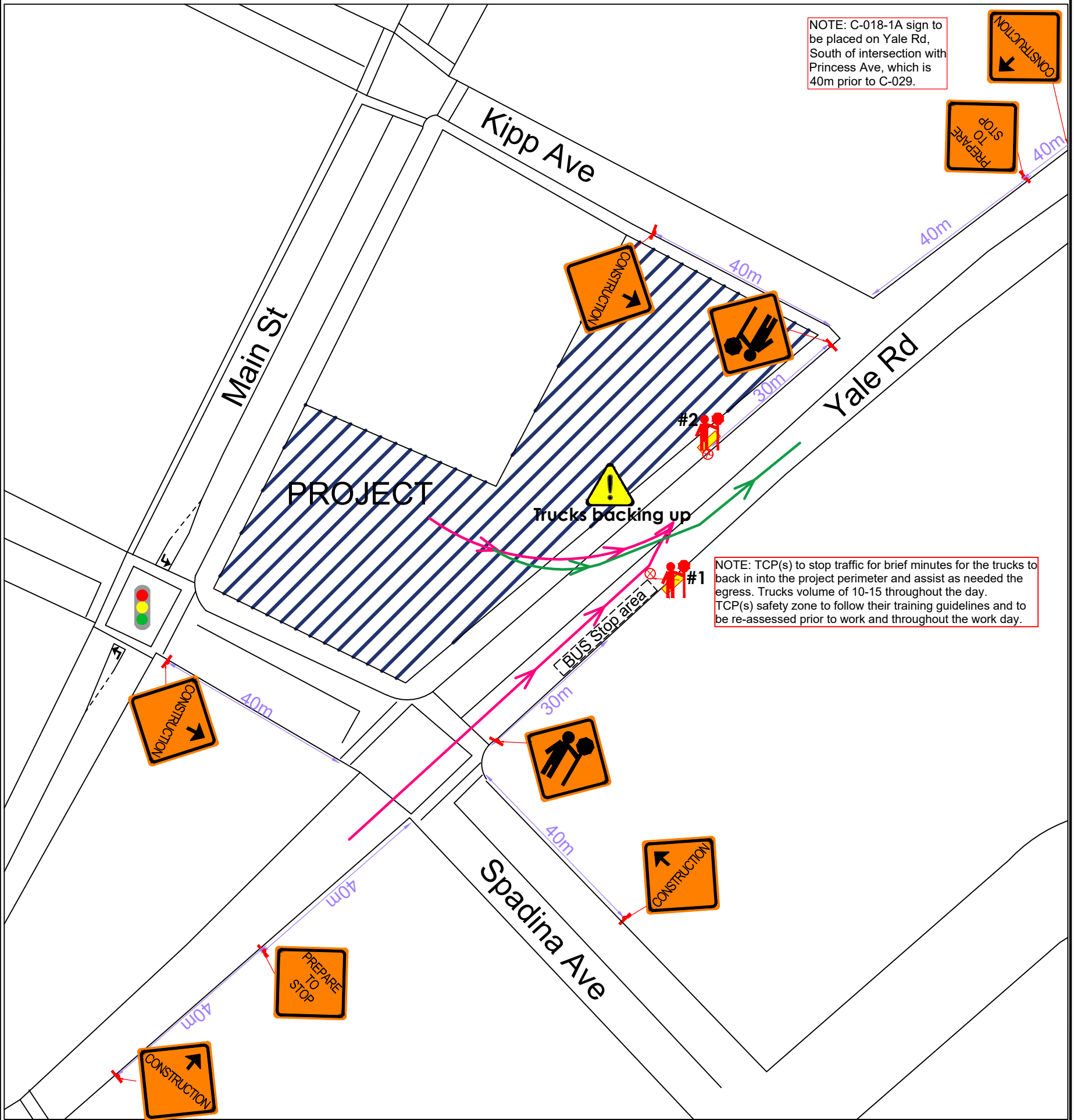

LEGEND:

- Project Area
- Truck Access
- Truck Egress
- Traffic Control Person and its safety zone
- Sign Location



Construction ahead
(C-018-1A)



Traffic Control
Person Ahead
(C-001-1)



Prepare to stop
(C-029)

VANMAR CONSTRUCTORS 1099 INC.

PROJECT: MQWS SPADINA - 45835 Spadina Ave, Chilliwack, BC

PURPOSE: Intermittent stoppage of the traffic for the trucks access and egress the project



SCALE:
NTS

DATE:
2025-04-11

CONTRACT NO:

DWG NO:
01/01

REV:
0

BY:
AF

NOTES:

- Dates:
Hours: 7am-5pm (weekdays) and 10am to 5pm (Saturdays)
Note: Noise variance to be applied to out of working hours.
- Traffic based on a 50 km/h speed zone
- TCP's to assist truck access and egress, pedestrians and potential cyclists;
- Advanced Warning Sign distances may be shortened to suit urban block length;
- Project Category 1 (Initial Project Category Determination 1 x Project Risk Low); See Traffic Control (Layout) Risk Assessment attached;
- Contractor/Employer is responsible for completing a risk assessment and review/update as required, provide a qualified Supervisor and meet or exceed the requirements of MOTI 2020 TMM and WSBC Part 18;
- Contractor/Employer must ensure the Traffic Control Plan Layout approved by Road Authorities is followed. Any deviation must be re-assessed, reviewed and approved prior to changes taken place.
- Figure# NA. General Application of TMM for Work on Roadways (2020) used as reference;

We the safe

We the Safe Consulting
604.299.8217|wethesafe.com
LAYOUTS FOR:
Site Safety Plans|Construction Fire Safety Plans
Crane Safety Plans|Traffic Management Plans